

Public Document Pack



Please ask for: Democratic Services
Direct Dial: (01892) 554413
E-mail: committee@tunbridgewells.gov.uk
Date: Tuesday 28 November 2023

Dear All

PLANNING COMMITTEE - WEDNESDAY 6 DECEMBER 2023

I enclose, for consideration at the next meeting of the Planning Committee on Wednesday 6 December 2023, the following items that were unavailable when the agenda was published.

Agenda No	Item
------------------	-------------

- | | |
|-----|---|
| (A) | <u>Application for Consideration - 23/01122/FULL 5 Calverley Park, Royal Tunbridge Wells, Kent.</u> (Pages 2 - 4) |
| (B) | <u>Application for Consideration - 23/01123/LBC 5 Calverley Park, Royal Tunbridge Wells, Kent.</u> (Pages 5 - 7) |

Kind regards,

Emer Moran
Democratic Services

Encs

Planning Committee
6 December 2023

APPLICATION PROPOSAL	Ref No 23/01122/FULL
Replacement of existing garage/shed/conservatory with a two-storey rear and side extension incorporating a double garage, revisions to internal layout of the main dwelling at ground and first floors and alterations to external facades	
ADDRESS: 5 Calverley Park, Royal Tunbridge Wells, Kent, TN1 2SH	

Condition Summary

- (1) Implementation Condition
- (2) Approved Plans
- (3) Tree Protection
- (4) Windows
- (5) Restrictions on Accommodation Above The Garage

Planning Committee
6 December 2023

Site Location Plan (Postcode: TN1 2SH)



Block Plan

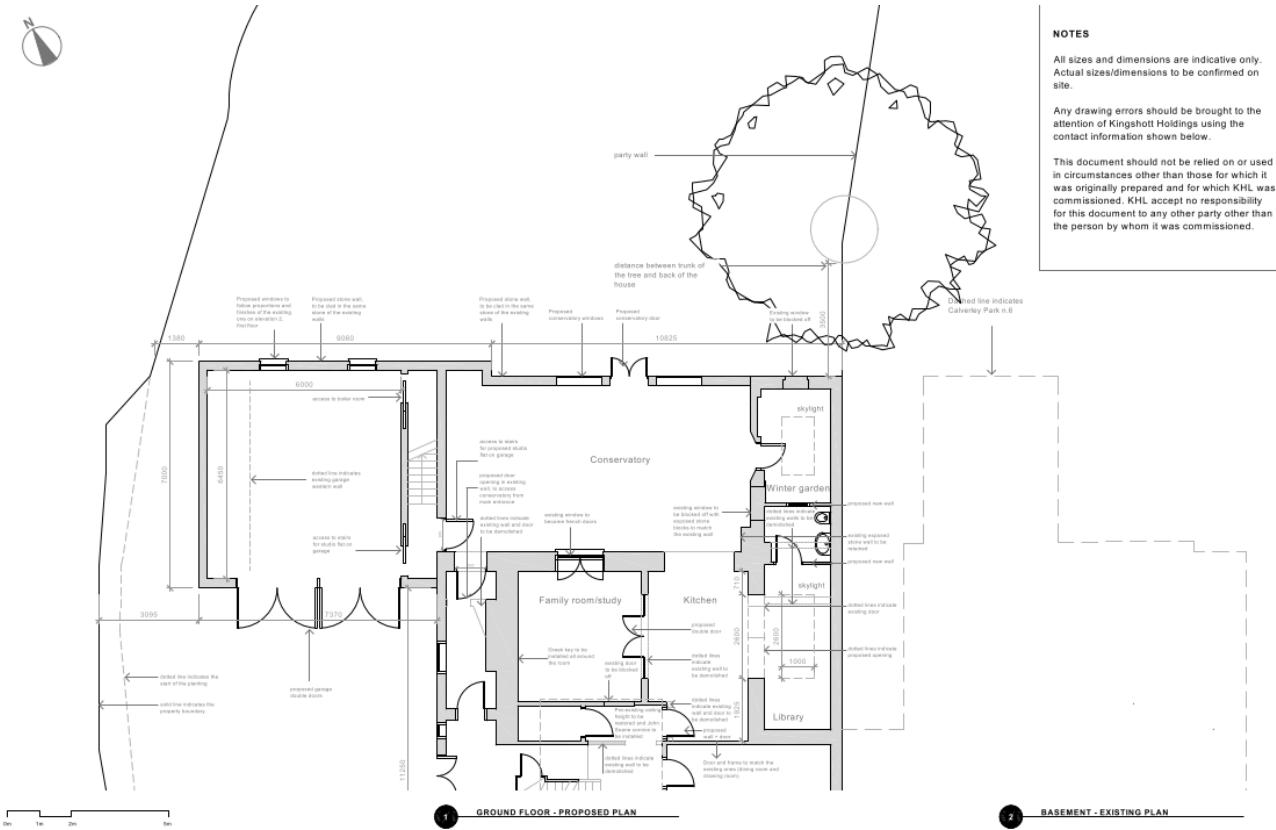

NOTES

All sizes and dimensions are indicative only. Actual sizes/dimensions to be confirmed on site.

Any drawing errors should be brought to the attention of Kingshott Holdings using the contact information shown below.

This document should not be relied on or used in circumstances other than those for which it was originally prepared and for which KHL was commissioned. KHL accept no responsibility for this document to any other party other than the person by whom it was commissioned.

APPLICATION PROPOSAL	Ref No 23/01123/LBC
Listed Building Consent - Replacement of existing garage/shed/conservatory with a two-storey rear and side extension incorporating a double garage, revisions to internal layout of the main dwelling at ground and first floors and alterations to external facades.	
ADDRESS: 5 Calverley Park, Royal Tunbridge Wells, Kent, TN1 2SH	

Condition Summary

- (1) Implementation Condition
- (2) Approved Plans
- (3) Stonework
- (4) Slates
- (5) Windows and Door Joinery
- (6) Roof
- (7) External Walls
- (8) First Floor Window to Door Restrictions

Planning Committee
6 December 2023

Site Location Plan (Postcode: TN1 2SH)



Block Plan

